

## VP Type Lever Block (Aluminum alloy)

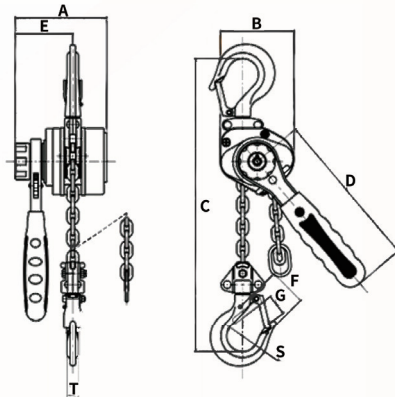

### Features:

- Attractive high-quality aluminium housing.
- Small size allows operation and storage in tight places.
- Easy handing with low physical effort on the lever.
- Fully protected mechanism for low maintenance cost.
- Easy adjustment by free chaining mode.
- Load drop protection in free-wheeling position.



Lifting



Lowering



Fastening



Pulling

| Model   | Capacity (t) | Standard Lift (m) | Test Load (t) | No.of falls of load chain | Load chain diameter (mm) | Dimension(mm) |    |     |     |     |      |      |      |    | Net Weight (kg) |
|---------|--------------|-------------------|---------------|---------------------------|--------------------------|---------------|----|-----|-----|-----|------|------|------|----|-----------------|
|         |              |                   |               |                           |                          | A             | B  | C   | D   | E   | F    | G    | S    | T  |                 |
| VP02515 | 0.25         | 1.5               | 0.375         | 1                         | 3.2                      | 87            | 68 | 200 | 145 | 320 | 55.5 | 35.5 | 32   | 11 | 1.5             |
| VP05015 | 0.5          | 1.5               | 0.75          | 1                         | 4                        | 100           | 81 | 250 | 160 | 320 | 62.5 | 42   | 34.5 | 12 | 2.5             |

## G80 Hoist Chain

### Features:

- Hoist special chain
- Alloy steel material
- High temperature heat treatment

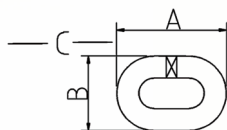

| Model   | Capacity (t) | Chain Size (mm) | Dimension(mm) |      |    | kg/m |
|---------|--------------|-----------------|---------------|------|----|------|
|         |              |                 | A             | B    | C  |      |
| TN-03   | 0.15         | 3               | 15            | 10.2 | 9  | 0.2  |
| TN-04   | 0.3          | 4               | 20            | 13.2 | 12 | 0.35 |
| TN-05   | 0.6          | 5               | 24.5          | 17   | 15 | 0.55 |
| TN-06   | 1            | 6               | 29.5          | 20.5 | 18 | 0.81 |
| TN-06-3 | 1.1          | 6.3             | 31            | 21.3 | 19 | 0.87 |
| TN-07-1 | 1.5          | 7.1             | 35            | 23   | 21 | 1.1  |
| TN-08   | 2            | 8               | 39.4          | 26.8 | 24 | 1.4  |
| TN-09   | 2.5          | 9               | 44.8          | 29.9 | 27 | 1.8  |
| TN-10   | 3.15         | 10              | 49.5          | 33   | 30 | 2.18 |

• Note: We reserve the right to change parameters without prior notification.